

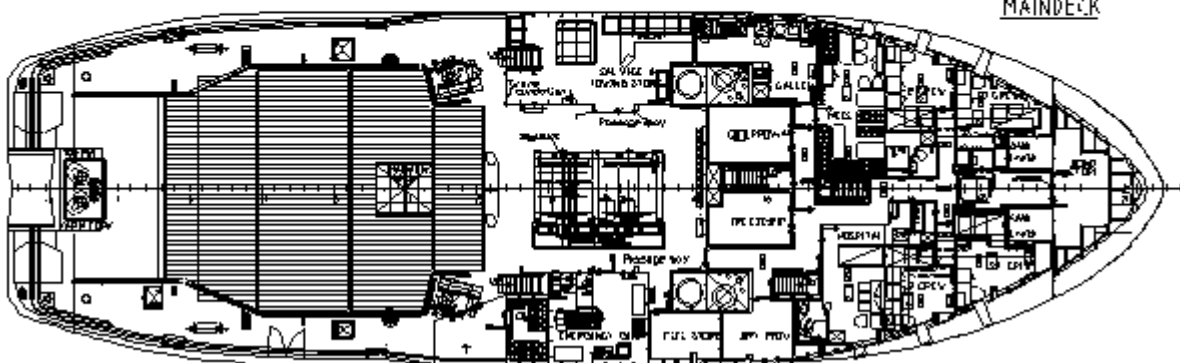

AHT "PRIMUS"

104 t bollard pull cont. – 8.100 bhp – built 2005

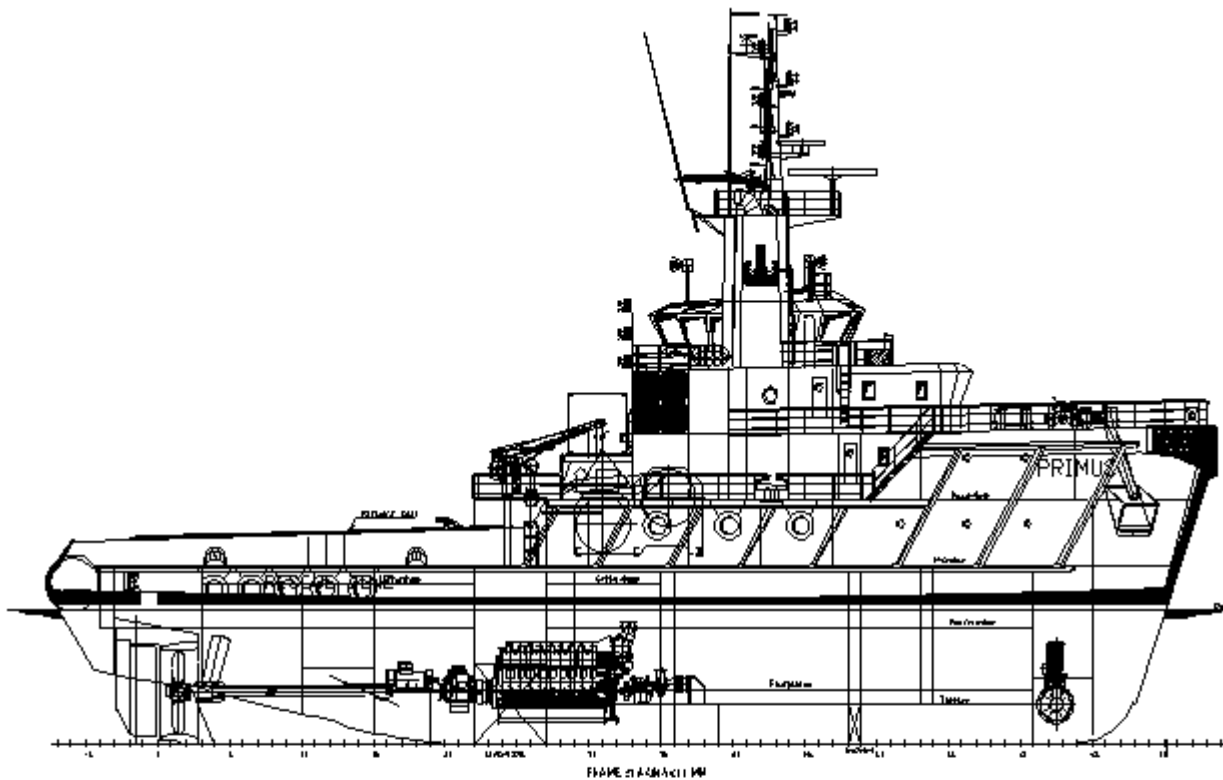

URANUS-class



JANUS-class



MAGNUS-class



PRIMUS-class



General data

Owner	Harms Offshore AHT "PRIMUS" - Hamburg, Germany	
Type	Anchor Handling Tug	
Design	MAN Ferrostaal AG / Hitzler Werft	
Classification	Germanischer Lloyd + 100 A5 E2 Deep Sea Tug Boat (Area-A4) + MC E2 AUT, FF1	
Built	2005 – Mützelfeldt Yard, Cuxhaven	
Registered	St. John's	
Flag	Antigua & Barbuda	
Call sign	V20Y1	
IMO number	9321287	
Basic functions	Long distance towing/ anchor-, hose handling/ berthing/ fire fighting/ salvage	

Main Dimensions

Crew	10	
Dimensions	Length o.a.:	48,81 m
	Beam o.a.:	13,80 m
	Depth to maindeck:	7,00 m
	Max. Draught:	6,00 m



Tonnage

GRT	1.262
NRT	378

Accommodation

Total Capacity	17 persons
officer single berth cabins with separated bedroom	4
officer single berth cabins	3
crew single berth cabins	6
crew double berth cabins	2



Towing / Anchor Handling

Bollard pull	104 t cont., 8.100 bhp
Winch	Hatlapa AH 1.000 Waterfall electr. driven 100 t at 15 m/min; 5t at 60m/min.
Main towing wire	1.200 m, 70 mm Ø
Spare wire	800 m, 70 mm Ø
Working wire	250 m, 70 mm Ø



Tank Capacities

Heavy fuel oil	475 cbm
Marine diesel oil	227 cbm
Fresh water	85 cbm
Evaporator	5 cbm/day
Ballast water	145 cbm





Salvage Equipment	2 portable diesel-driven salvage pumps Workboat with 50 bhp outboard engine
Nautical / Communication Equipment	Searchlights 3 x remote controlled Radar system 2 x ARPA combined with ECDIS GMDSS equipment A4 Pos. system Joy stick system LIPS DEBEG 4112 Satlog Inmarsat Phone / Fax / Email / Telex All modern nautical equipment to highest standard
Auxiliary Equipment	Shaft generators 2 x 800KW/840 kVA Generator set 1 x Caterpillar 3412 C, 534 kW Capacity 625 kVA/500KW, 50 Hz, 230/ 400 V Fire fighting pump 2 x 1512 cbm / h each at 14 bar Bowthruster electr. driven 400 kW CPP LIPS Fire fighting Monitor 2x1200cbm/h
Deck lay-out	Deck area 172,38 sqm Free Deck area 155,00 sqm Tugger winches 2 x, 110 m steel wire with 18 mm diameter Deck crane Hydraulic crane 4 t at 12 m Fork/ towing pins Karmoy, 300 t SWL Stern Roller 250 t SWL, 3,00 m length, 2,00 m Ø Anchor 2 high speed anchor winches warping head
Speed / Consumption	Maximum 16,5 kn, 28,8 t/ 24 hrs Economical 14,0 kn, 22 t/ 24 hrs Towing Max. 28,8t/ 24 hrs
Propulsion System	Main engines 2 x MaK 9M25 Max power 5.940 kW at 750 rpm Gearboxes 2 x Reintjes Propulsion 2 x controllable pitch propeller Diameter 2 x 3.200 mm in HR nozzles Rudders 2 x flap type high performance rudders

